

# Nottingham Ridge Logistics Center

**FOR LEASE**  
Ready for Occupancy | 54,121 SF

5301 Nottingham Drive  
White Marsh, Maryland 21236



## Location Proximity

- 1.0 Mile I-95
- 12.0 Miles Port of Baltimore
- 4.0 Miles I-695 / Baltimore Beltway
- 22.0 Miles BWI / Thurgood Marshall Airport

## Project Highlights

- Excellent I-95 Visibility/Location Access
- 54,121 SF Available
- Class A Master Planned Park
- Excellent proximity to nearby White Marsh amenities
- Ready for Occupancy
- Demised with Speculative Office 2,000 SF +/-



To see more properties like this one,  
please visit our website: [www.cregllc.com](http://www.cregllc.com)

1343 ASHTON ROAD SUITE B , HANOVER, MD 21076  
main (410) 787-8799 • fax (410) 787-8872

**SCOTT SKOGMO, SIOR**  
443.883.8180  
sskogmo@cregllc.com

**ED BRADY**  
443.883.8170  
ebrady@cregllc.com

**MATT LARAWAY, SIOR**  
443.883.8182  
mlaraway@cregllc.com



# PREMISES PLAN

5301 Nottingham Drive

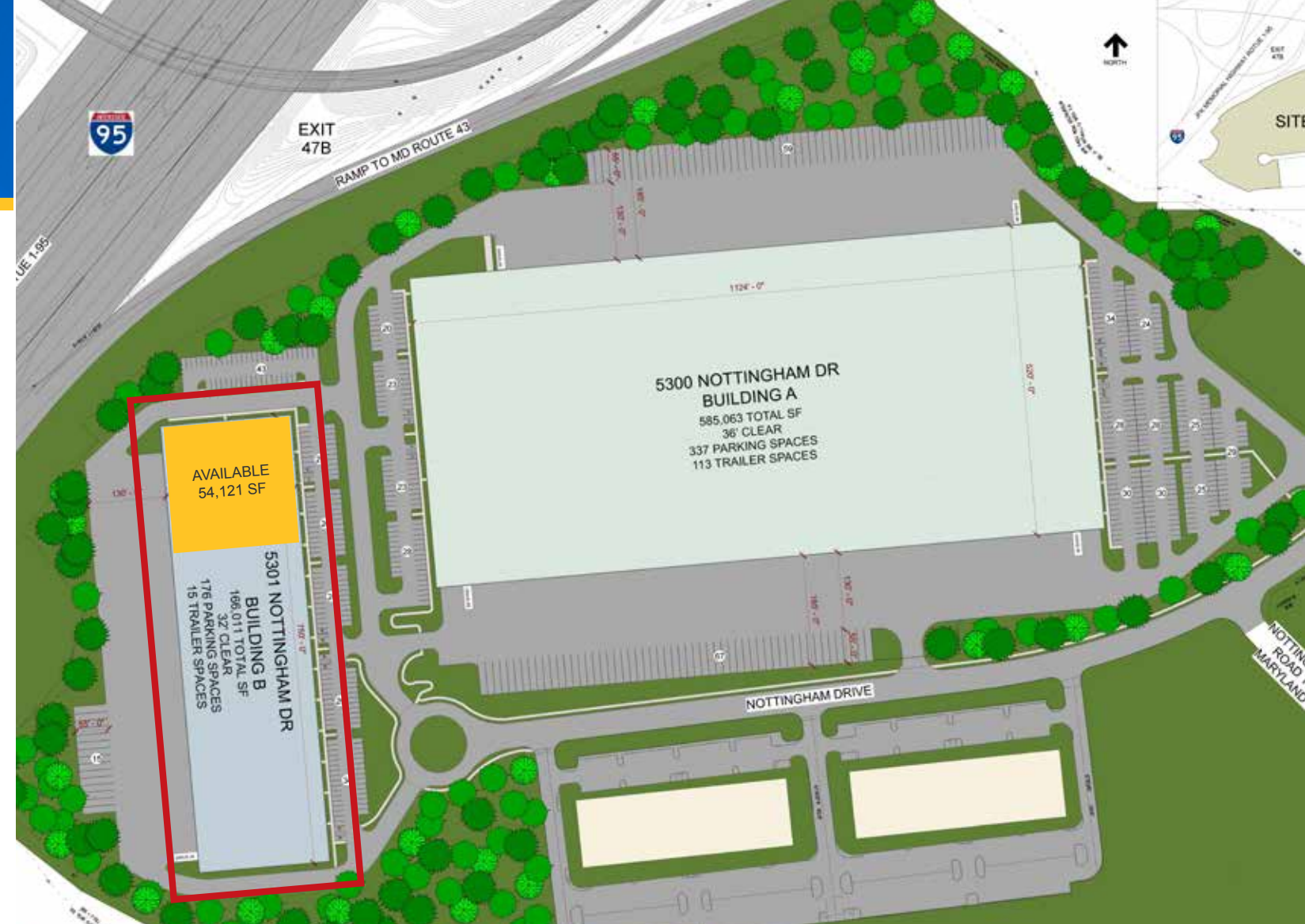
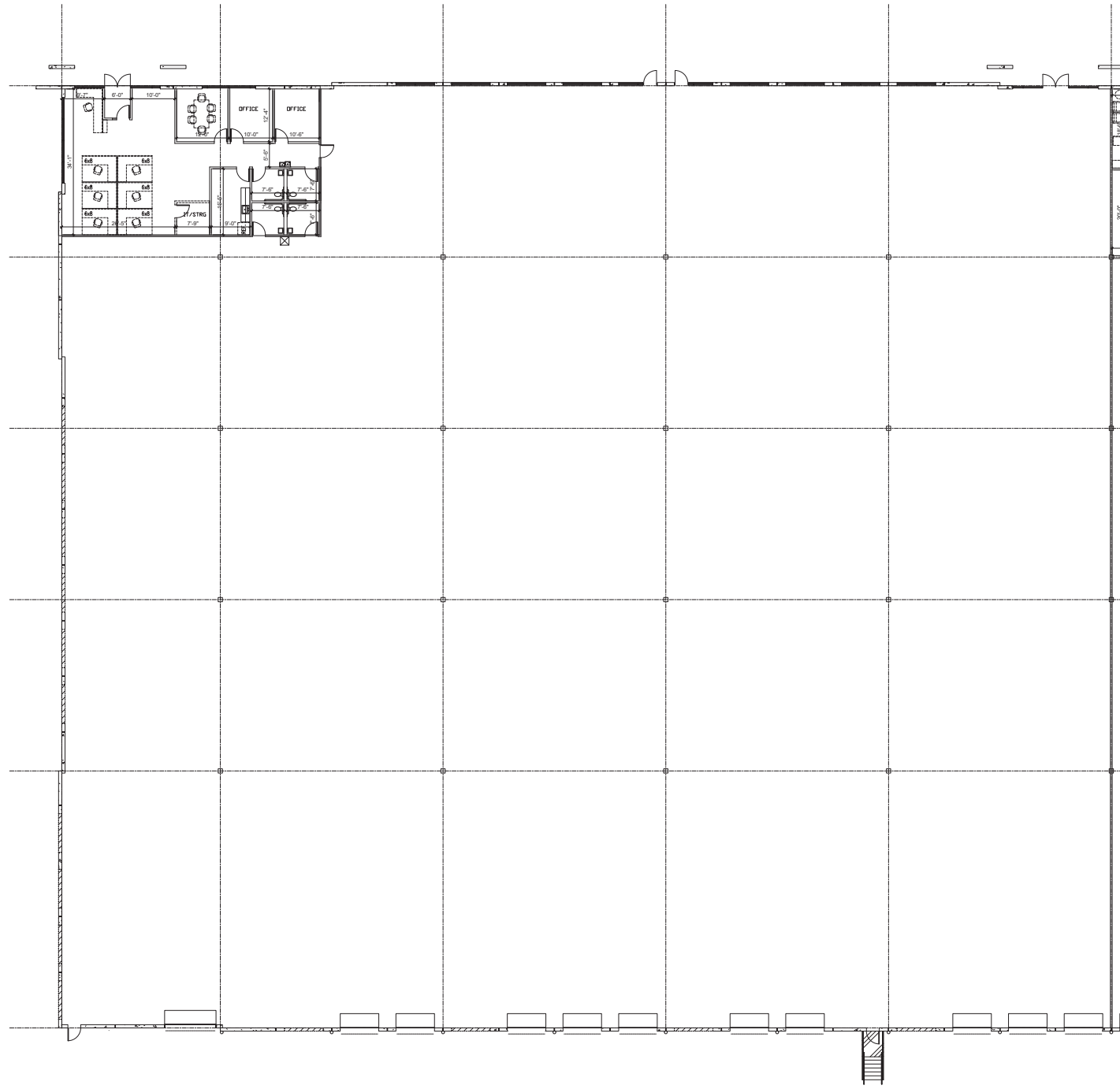

## BUILDING PREMISES

**BUILDING SIZE**  
166,011 SF (54,121 Available)

**PREMISES DIMENSIONS**  
245ft x 221ft

**CEILING HEIGHT**  
32ft Clear

**COLUMN SPACING**  
52ft x 40ft, 60ft Loading Bay

**TRUCK COURT**  
130ft Minimum

**DRIVE-IN DOORS**  
1 (12ft x 14ft)

**DOCK DOORS**  
10 (9ft x 10ft)

**CONSTRUCTION TYPE**  
Concrete Tilt-Up

**ROOF**  
TPO 60 Mil Mechanically Attached

**FLOOR**  
7in Concrete

**LIGHTING**  
LED @ 25 Foot Candles

**SPRINKLER SYSTEM**  
ESFR

**ZONING**  
ML - MH

