

SAA
 ARCHITECTURE LLC.
 Architecture / Planning
 Striking, Functional,
 Innovative Architecture
 www.DesignedToLast.com

WASHINGTON OFFICE
 8101 Sandy Spring Rd.
 Suite 105
 Laurel, MD, 20707
 phone 301.513.0800
 fax 301.513.0155

©SAA ARCHITECTURE LLC. 2017
 This drawing may be utilized only for the purpose of constructing or installing the work shown thereon at the site of the work specified. Any other use of the drawing, including without limitation any reproduction or alteration of this drawing, without the prior written approval of SAA Architecture LLC, is prohibited.

"Professional Certification. I hereby certify that these documents were prepared or approved by me, and that I am a duly licensed Professional Architect under the laws of the state of Maryland, License No. 3329-A, Expiration Date: 9/14/2017"

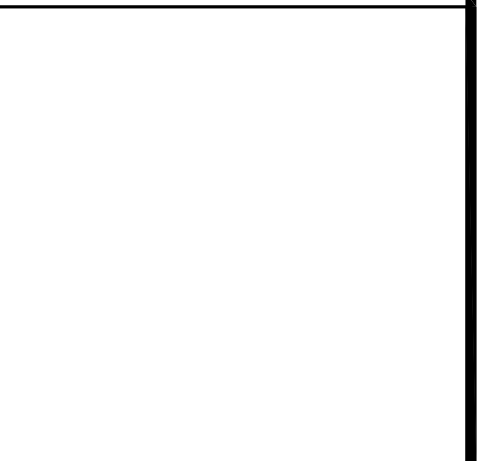

MARKETING PLAN
 1400 BUSH ST
 BALTIMORE, MD 21230

It is the intent of these drawings and specifications to produce a complete project. In all cases the drawings and specifications must be reviewed, priced, estimated, and constructed in their entirety. The drawings are complementary to one another and the specifications. Anything shown or implied on any one drawing must be provided, installed and connected as though it was shown on all drawings and included in the original pricing. No request for additional cost, or change orders will be accepted by the owner from any contractor, subcontractor, supplier or installer that result from a failure to thoroughly review ALL the drawings, coordination with other trades, or thoroughly inspect the site to determine all existing conditions.

A	6-14-17	MV	REVIEW
MARK	DATE	MGR	RELEASE
SHEET STATUS			

BUILDING PLAN

DRAWN BY: KB

CHK'D BY: RGS

JOB NO. 2017057

SHEET NO. A.1.0

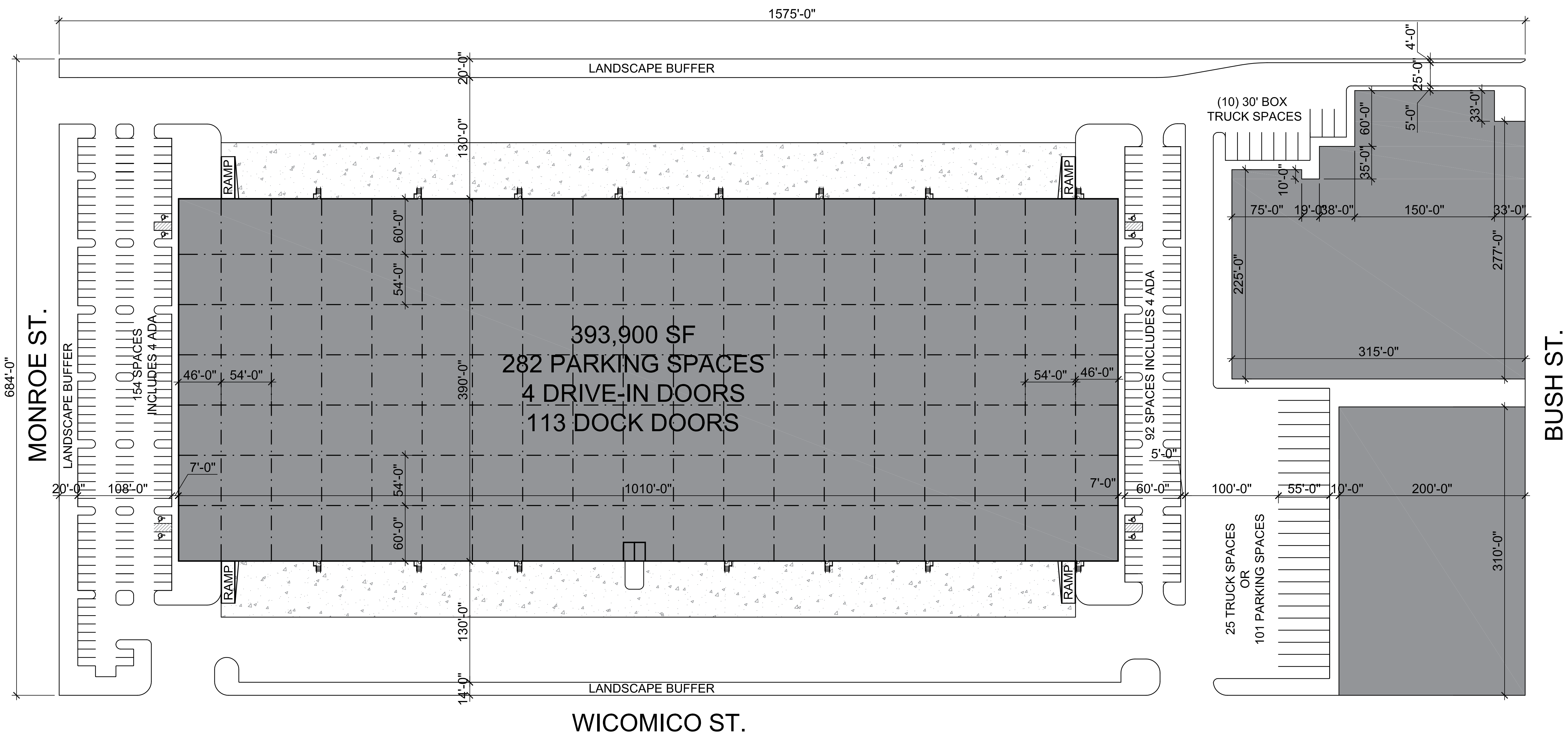
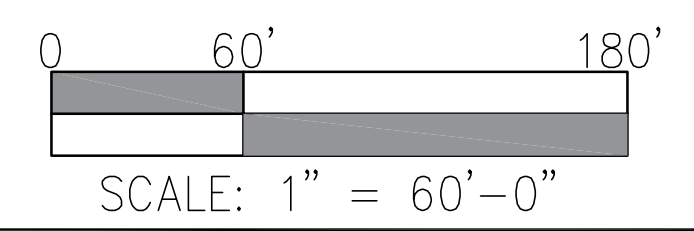

WICOMICO ST.

MONROE ST.

BUSH ST.

393,900 SF
 282 PARKING SPACES
 4 DRIVE-IN DOORS
 113 DOCK DOORS